

Thos Fitzsimons

Patrick More.

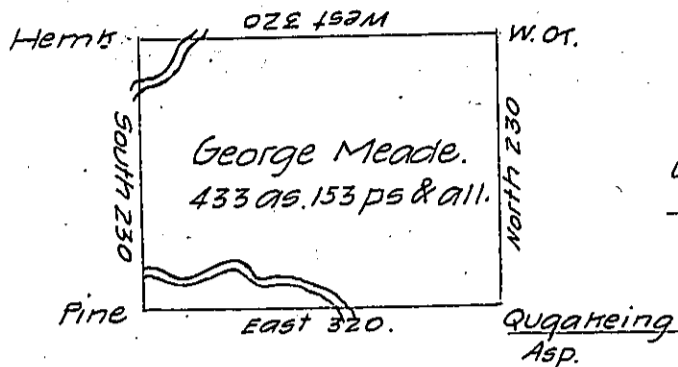

Claimed by  
— Levy & Co.

Robert Gray

Situate in Huntingdon County Frankstownship on big Mo-  
shannon Creek containing 433 acres 153 perches and the usual  
allowance for Roads. Surveyed the 25<sup>th</sup> day of June 1793. in persew-  
ance of a Warrant dated the 3<sup>rd</sup> day of August 1792.

John Caran D.S.

Daniel Brodhead Esqr. S.G.

IN TESTIMONY that the above is a copy of the original remaining on file in  
the Department of Internal Affairs of Pennsylvania, made  
conformably to an Act of Assembly approved the 16<sup>th</sup> day of  
February, 1833, I have hereunto set my Hand and caused  
the Seal of said Department to be affixed at Harrisburg,  
this sixteenth day of March 1906

*Isaac S. Brown*  
Secretary of Internal Affairs